

July 13, 2017

Mr. John Sherman
Holley Central School District
3800 North Main Street
Holley, New York 14470

Re: Environmental Water Sampling – Holley Junior Senior High School

Dear Mr. Sherman,

Envoy Environmental was contracted on June 23, 2017 to perform additional Environmental Water Sampling at Holley Junior Senior High School located at 16848 Lynch Road in Holley, New York. We understand the Holley Central School District is evaluating the data based on the NYS Department of Health (“NYSDOH”) Emergency Regulation, Lead Testing in School Drinking Water (Subpart 67-4) as well as the EPA’s 3T’s for Reducing Lead in Drinking Water in Schools Guidance Document. All sampling conducted was done in accordance with the NYSDOH regulations as it pertains to testing schools for lead in the drinking water.

Samples taken were based on both the direction of the client, and areas designated as high priority as outlined by the NYSDOH regulations. All water samples collected were 250 mL and taken as a “first draw” from each testing location. First draw samples are defined as a sample of tap water, collected in accordance with the NYSDOH regulations, that has been standing in plumbing pipes at least 8 hours and not more than 18 hours and is collected without prior flushing of the tap. The “flush” samples were collected in 250 ml bottles and after the water from the outlet flowed for 30 seconds for taps and 15 minutes for water coolers. The NYSDOH regulations identifies the Action Level at 15 ppb.

Water sampling analysis was contracted through Environmental Hazards Services, LLC located in Richmond, Virginia. The sampling and analytical testing was conducted in compliance with the USEPA Requirements for Lead Sampling and Testing Protocols. The following USEPA Methodologies were used to prepare and analyze the Holley CSD drinking water samples for Lead:

Drinking Water Sample Preparation	USEPA Method 200.2
Lead by AA-Graphite Furnace	SM 3113B-2010

Each sample was preserved, at Environmental Hazard Services, LLC, with nitric acid to reduce the pH to less than 2 as per USEPA Method 200.2.

Chain of Custody (“COC”) forms are used to document the history of sample possession from the time the sample containers leave their point of origin to the time the samples are received by the laboratory.

In Table 1 of this report we have listed the water samples results.

TABLE 1

Holley Junior Senior High School						
Sample ID	Water Source	Level Detected (PPB) 9/20/16 & 9/21/17	Level Detected (PPB) 1/12/17		Level Detected (PPB) 6/23/17	Results
HS-1-KS-02	Kitchen Sink	40	First Draw	23	4.94	Outlet is below the NYSDOH Action Level
			Flush	0.62	<1.00	

Please refer to the attached laboratory reports for specific analytical data and sample locations throughout the school. If you have any questions, please contact me at (585) 454-1060. We appreciate the opportunity to provide you with our professional services.

Sincerely,



Ted Knapp
Project Manager
Envoy Environmental Consultants, Inc.



Environmental Hazards Services, L.L.C.
 7469 Whitepine Rd
 Richmond, VA 23237
 Telephone: 800.347.4010

Lead in Drinking Water Analysis Report

Client: Envoy Environmental
 57 Ambrose St
 Rochester, NY 14608

Report Number: 17-06-03737
 Received Date: 06/27/2017
 Reported Date: 07/11/2017
 Sampled By: Anthony Ellwanger
 Tech Certification #:

Project/Test Address: E17-0826; Holley Jr/Sr HS; 16848 Lynch Rd.; Holley, NY 14470

Client Number:
 33-5448

Laboratory Results

Fax Number:
 585-454-1062

Lab Sample Number	Client Sample ID	Collection Date	Collection Location	Concentration ug/L (ppb)	Analysis Date	Narrative ID
17-06-03737-001	HS-1-KS-02-C	06/23/2017	KITCHEN SINK 1ST DRAW	4.94	07/10/2017	
17-06-03737-002	HS-1-KS-02-D	06/23/2017	KITCHEN SINK FLUSH	<1.00	07/10/2017	

Method: SM 3113B-2010
 Accreditation #: NY 11714

Reviewed By Authorized Signatory:

Julie Dickerson
 Laboratory Administrator

Sample Results denoted with a "less than" (<) sign contain less than the reporting limit which is 1 ppb.

The EPA Maximum Contaminant Level for Lead in Drinking Water is 15 ppb. The results herein conform to NELAC standards, where applicable, unless otherwise narrated on this report. Results represent the analysis of samples submitted by the client. Sample location, description, field parameter results, etc., were provided by the client. This report cannot be reproduced, except in full, without written approval from Environmental Hazards Services, L.L.C.

LEGEND ug/L= micrograms per liter ppb = parts per billion



EHSO Laboratories™

Environmental Hazards Services, LLC
www.ehsolabs.com
8889 347-4010
4800 278-4807 (tand)

2489 Whitesboro Rd
Richmond VA 23237

Analysis by National Tasting Lab

WaterSmart® P1
LEAD ONLY
Chain-of-Custody



17-06-03737

Due Date:

07/04/2017
(Tuesday)

AE MC

Send Lab Use Only
SEND SAMPLES TO
356 S. Mansfield St.
Ypsilanti, MI 48197

Company Name: Envoy Environmental Address: 577 Ambrose St

Redelegate Dr. 14608

Phone: 888 454-1060 Fax: 888 454-1062 E-mail: TKrupp@envoyenvironmental.com Acct Number: 14470

Project Name/ Testing Address: Holley Senior Center / Seniors Kitchen City/State/Country: Holley NY Age of Project: 20

Collected by: Anthony Filiburger Certification #: 1111 Wet Tag # (if applicable):

Purchase Order Number: Requisitioned by: Date:

ALL SAMPLES MUST BE STORED AT 4°C OR COLDER UNTIL ANALYSIS. ALL SAMPLES MUST BE ANALYZED WITHIN 30 DAYS OF COLLECTION. ALL SAMPLES MUST BE ANALYZED WITHIN 30 DAYS OF COLLECTION. ALL SAMPLES MUST BE ANALYZED WITHIN 30 DAYS OF COLLECTION.

No	Client Sample ID	Collection Location (Rt. Kitchen Sink)	Collection Date	Collection Time	Analyte Requested	Field Parameters		
						Field pH	Field Chlorine	Temperature at Time of Collection
1	HS-1-KS-02-C	Kitchen Sink (Rt. Kitchen Sink)	6-23-17	0648	Lead			
2	HS-1-KS-02-D	Kitchen Sink (Front)	6-23-17	0649	Lead			
3					Lead			
4					Lead			
5					Lead			
6					Lead			
7					Lead			
8					Lead			
9					Lead			
10					Lead			

Requested by: GPBG Date: 6/27/17

Requested by: Date:

NTL Lab ID Number

Client: Holley Central School District
Location: Holley Junior & Senior High School
Work Performed: Water Re-Testing
Date: June 23, 2017
Job Number: E17-0826

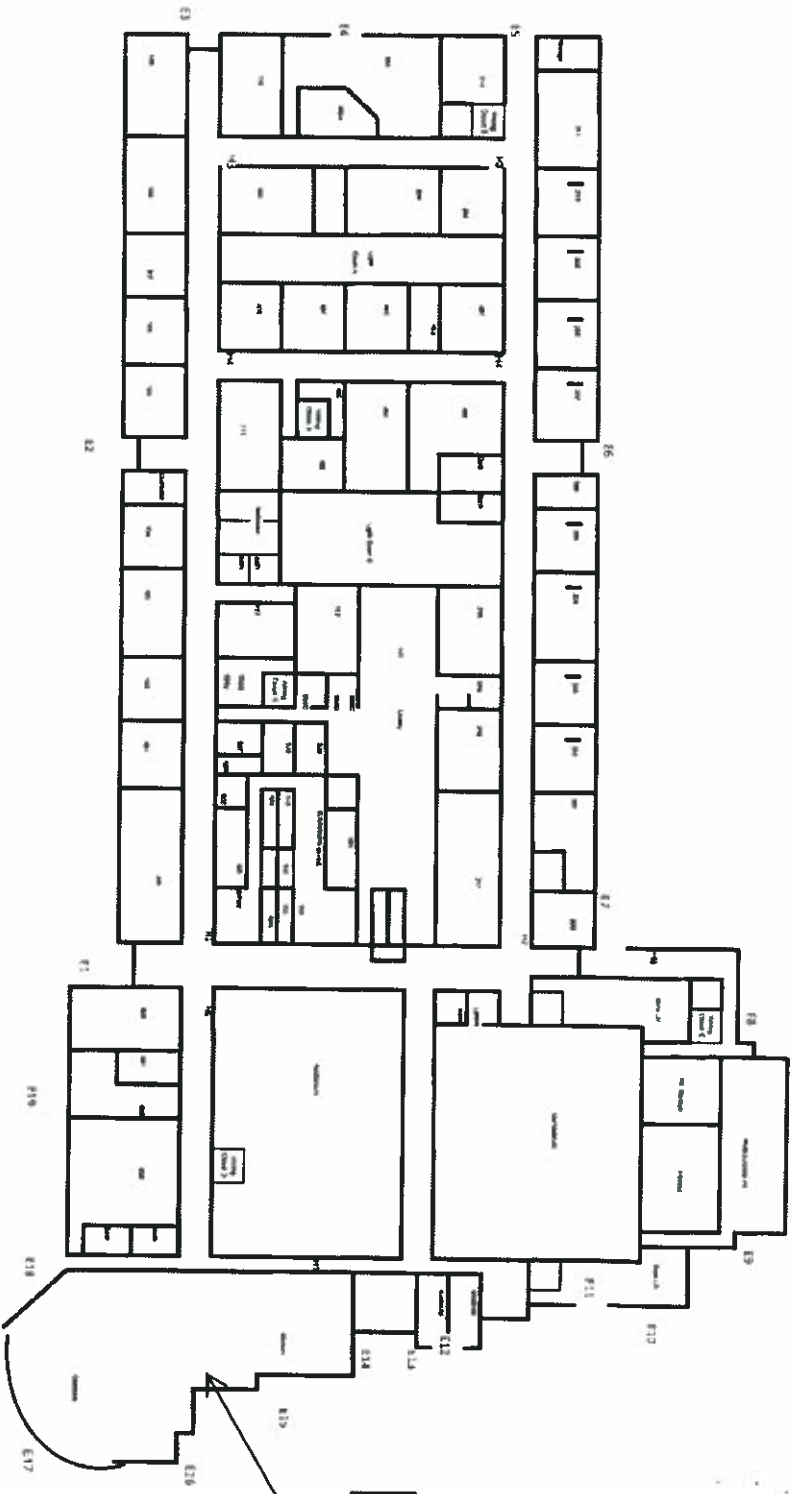

HS-1-KS-02C
HS-1-KS-02D